



NK 35/30 TN

- Popular item

Needle roller bearings with machined rings, without an inner ring

Bearing data

[Tolerances](#),

Normal, P6, P5, ISO - F6 (Fw),

[Radial internal clearance](#),

table

Design considerations

[Housing tolerances](#),

table,

[Shaft tolerances](#),

[Operating clearance](#)

Technical specification

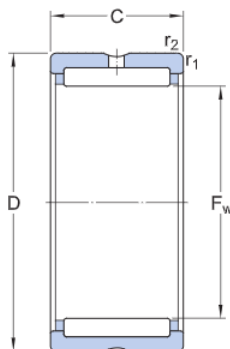

DIMENSIONS

F_w	35 mm	Diameter under rollers
D	45 mm	Outside diameter
C	30 mm	Width
$r_{1,2}$	min.0.3 mm	Chamfer dimension outer ring

ABUTMENT DIMENSIONS

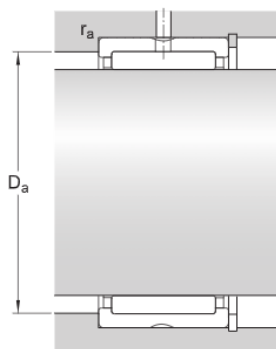

D_a	max.43 mm	Abutment diameter housing (with flanges)
r_a	max.0.3 mm	Fillet radius

CALCULATION DATA

Basic dynamic load rating	C	40.2 kN
Basic static load rating	C ₀	85 kN
Fatigue load limit	P _u	10.6 kN
Reference speed		11 000 r/min
Limiting speed		13 000 r/min

MASS

Mass bearing	0.11 kg
--------------	---------

ASSOCIATED SEALS

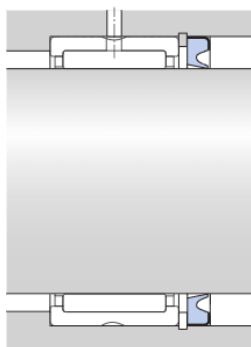

Radial shaft seal with a low cross-sectional height, single lip	G 35x45x4	Radial shaft seal with a low cross-sectional height, single lip
Radial shaft seal with a low cross-sectional height, double lip	SD 35x45x4	Radial shaft seal with a low cross-sectional height, double lip